



NOW is the TIME | generosity initiative



Northwest Christian Church
1306 N Stanley Ave
Decatur IL 62526

RETURN SERVICE REQUESTED

NON-PROFIT
ORGANIZATION
U.S. POSTAGE
PAID
DECATUR, IL
PERMIT NO. 135



Northwest Christian Church

A growing family journeying together to be more like Jesus

NOW is the TIME

— for our —
BUILDING
to reflect our vision

— by —
creating a more
WELCOMING
environment

— and by —
INVESTING
in the next
generation

ONCE UPON A TIME...

The last five years have really been a defining time for us as a church. The vision for this renovation and building project has been influenced by the journey we have been on together. Here is a brief recap:

SEPTEMBER 2010: God opened the door to a partnership with Oak Grove School. The Back Snack program allowed us to make sure that kids in our neighborhood had food to eat over the weekend. It was during this time that God really began to give us a heart for our neighborhood and being good neighbors.

DECEMBER 2011: We made the decision to go from two different styles of worship to one. God was stirring in our leadership a belief that He wanted us to be a more unified church: one family, worshiping the same way together as Jesus envisioned in John 17.

MAY 2012: We wanted to invest in the facilities for our next generation, so we decided to paint new colors and do some minor renovations to our KidZone and Little Kidzone. While it was exciting to make these changes, we were frustrated that we couldn't do more. God was stirring in us a desire to make our facilities more attractive to guests.

SEPTEMBER 2012: After weeks of prayer, conversation, and working with a consultant we arrived at our new vision statement as a church: We are a growing family journeying together to be more like Jesus.

AUGUST 2013: Northwest Christian Campus, a school that met in our building for 25+ years, closed its doors. We began to have some conversations as a church about what to do with the space they had used and were led to consider the possibility of using the lower level as a student ministry space.

The renovation reflects the journey we have been on as a church. A renovated, larger foyer will give us the space we need to gather as a family on Sunday mornings and during the week. A renovated KidZone will help us create attractive spaces to minister to kids. A renovated lower level will give our youth ministry team space to invest in new generations.

The pages of this brochure are filled with descriptions and pictures of this renovation project. This project is about so much more than brick and mortar. It's about vision and our journey together as a family.

Steve Higgs



Did you know that Steve Higgs is the second longest-tenured Senior Minister in Northwest's history?

A GROWING FAMILY JOURNEYING TOGETHER TO BE MORE LIKE JESUS.

NOW IS THE TIME

— for our —
BUILDING
to **reflect** our **vision**

We are **growing**. No person or church is ever going to be a finished product this side of heaven; our church will continue to grow spiritually, relationally, and numerically. This project will create space in our building where we can grow together in these ways.

We are a **family**. Every home has comfortable common areas to be together as well as practical personal spaces for each member to call their own. This project will address needs in our common areas with a foyer expansion, portico, and new flooring. It will also address needs in our ministry spaces for children and students.

We are **journeying together**. While personal growth is important, we cannot be the people God has called us to be on our own; we need community. This project will provide spaces where community will develop and flourish.

We desire to become **more like Jesus**. We don't journey aimlessly, but we have a destination – becoming more like Jesus. This project will minimize some of the distractions of an aging building so that our focus can remain on ministry.

NOW IS THE TIME

— to —
create a more
WELCOMING
environment

In order to be a *growing* family, we need to invite guests to journey along with us. First impressions are vitally important for guests; we want the first spaces guests see when they arrive at Northwest to be welcoming spaces. This project will improve environments in our foyer, KidZone, and Sanctuary with updates and renovations that will make them as warm and friendly as our people.

NOW IS THE TIME

— for —
INVESTING
in the next
generation

Like the many dedicated Northwest saints who have come before us, we have a responsibility to set an example of faithfulness for those who will come after us in the future of Northwest. This project provides us with the opportunity to bless future generations the way we have been blessed by shaping spaces where we will welcome guests, fellowship, worship, and teach our children and youth about God's love for them.



Did you know that this church started because of a misprint in the Christian Standard?



Portico

- Dedicated main entrance
- Visibility from Center Street
- Sheltered drop-off

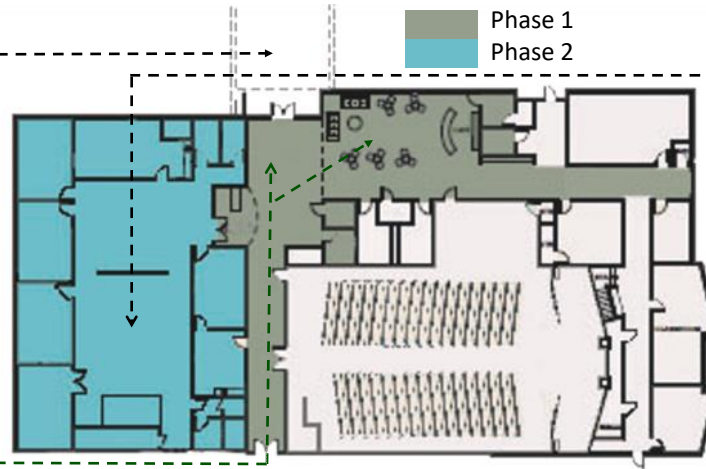

Maintenance

- KidZone flooring and HVAC
- New pitched roofs
- New sanctuary carpet
- New flooring in foyer and main hallways



KidZone

- Birth-5th grade all in one area
- Convert old kitchen/Connection Room into nursery
- Create preschool space with dedicated restroom
- Add an additional restroom for elementary area
- Convert storage and Shepherding Center rooms to KidZone break out spaces
- Relocate Shepherding Center to current nursery rooms



Remodeled Foyer

- Family room-style space for hospitality
- Vaulted ceiling and more natural light
- Expanded 1500 sq. ft. foyer
- Additional seating and gathering spaces
- Clear and secure KidZone check-in
- Family restroom and nursing area



Student Ministry

- Remove a wall in lower level to create a dedicated large-group space
- Renovate the space to be attractive to students
- New flooring and ceiling in breakout spaces



Did you know Northwest Christian Church and Mr. Potato Head share the same birth year? It was 1952.

YOUR PERSONAL COMMITMENT

The success of the **Now is the Time** generosity initiative depends upon each of us taking our generosity to the next level. The process of deciding what amount to commit is exciting, because we know we are contributing to God's Kingdom. The process is also challenging, because of the sacrifice it will require of us.

This guide is designed to help you think prayerfully and creatively about giving to the **Now is the Time** generosity initiative. Many people are amazed at how God responds to their willingness to give sacrificially toward His Kingdom purposes.

 MY GIVING POTENTIAL Each of us can give far more than we think by giving it over a two-year period. Here are some examples.		
Weekly Gift	Monthly Gift	2 Year Total Commitment
1,000	4,334	104,000
500	2,167	52,000
450	1,950	46,800
400	1,733	41,600
350	1,517	36,400
300	1,300	31,200
250	1,083	26,000
200	867	20,800
175	758	18,200
150	650	15,600
125	542	13,000
100	433	10,400
90	390	9,360
80	347	8,320
70	303	7,280
60	260	6,240
50	217	5,200
45	195	4,680
40	173	4,160
35	152	3,640
30	130	3,120
25	108	2,600
20	87	2,080
15	65	1,560
10	44	1,040
5	22	520

Here are a few questions to prayerfully consider as you make your commitment decision:

Does this amount really require a step of faith?

"And God is able to bless you abundantly, so that in all things at all times, having all that you need, you will abound in every good work."
- 2 Corinthians 9:8

Does this amount represent a genuine sacrifice?

"I will not sacrifice to my God an offering that costs me nothing!"
- 2 Samuel 24:24

Does this amount express the level of thanksgiving I have for how Christ and His church have blessed my life and my family?

"With a freewill offering I will sacrifice to you; I will give thanks to your name, O Lord."
- Psalm 54:6

Commitment Sunday is November 6. Everyone will be given a commitment card and envelope in advance. After prayerfully considering your role in the initiative, please complete your commitment card by:

- Enclosing a generous kick-off gift on November 6 for an amount that God lays on your heart.
- Writing down on your card the amount of your kick-off gift, any gift in kind (non-cash gifts you would like to contribute), and the amount you commit to give above and beyond your regular giving over the next two years.
- Bring your envelope with you to Northwest on Commitment Sunday. If you are not able to attend, please mail your card to the church.

CREATIVE WAYS TO GIVE:

- Income from tax returns
- Bonds/Stocks
- Garage sale or yard work
- Defer a major purchase
- Make NWCC a beneficiary in your will
- Donate assets as non-cash gifts
- Reduce your cell phone plan
- Start clipping coupons
- Cut your cable or ditch your dish
- Consider family activities like a car wash, lemonade stand or bake sale

COMMITMENT CARD	
With dependence on God, I support the Now is the Time growth and generosity initiative of Northwest Christian Church over a two-year period, by committing to the following:	
Name _____	
Address _____	
City _____	State _____ Zip _____
#1) Kick-off Gift (cash or check)	
\$ _____	To be given on Commitment Sunday, November 6, 2016
#2) Two-year Commitment	
\$ _____ a week for 104 weeks =	_____
\$ _____ a month for 24 months =	_____
\$ _____ a year for 2 years =	_____
#3) Gift in Kind (please describe gift below)	

Approximate cash value of gift \$ _____	
Total: Two-year total commitment	
\$ _____	PLEASE ADD TOTAL FROM SHADED BOXES ABOVE
Commitment Weekend November 6, 2016	



Did you know that over the last 4 years combined we've been within 1% of meeting our overall budget?

frequently asked QUESTIONS

When will construction begin?

We will evaluate our commitments and cash flow, and work with our consultants to start construction as soon as possible.

How will my Now is the Time giving remain separate from general church offerings?

We've set up a savings account for the **Now is the Time** giving and every dollar given for the generosity initiative will be deposited in this account.

How will the congregation be updated on progress?

Regular announcements will be shared from the stage and in the bulletin and church newsletter. We will keep everyone informed so that we can all celebrate together! You can also check our website for updates at:

<http://www.nwcchurch.org/now-is-the-time/>

What will happen if we miss our target?

We expect to reach the goal, challenging as it may be. We've prayed long and hard about it, and we believe God is calling us to pursue this. However, if we fall short, we will adjust expenditures based on priorities determined by the elders and leadership team at that time. Unless we fall well short of the goal, none of the projects will be totally eliminated.

\$750,000.00 for the renovation seems like a lot of money. Can we do this?

The elders and staff have been seeking God's will through prayer and fasting. As a result we believe this is God's vision for Northwest.

History has shown that God is faithful in accomplishing His purpose and vision and we are confident that He will be again.

Now is the Time to put our trust in God, as Jesus said in Matthew 19: "With man this is impossible, but with God all things are possible."

Dates to Remember

Town Hall Meeting

October 16, 19, & 23

24-hr Prayer Event

November 4

Commitment Sunday

November 6

Celebration Sunday

November 20



Did you know the last Capital Campaign held at Northwest was in the 1980s?